

1. About Mi Smart Socket

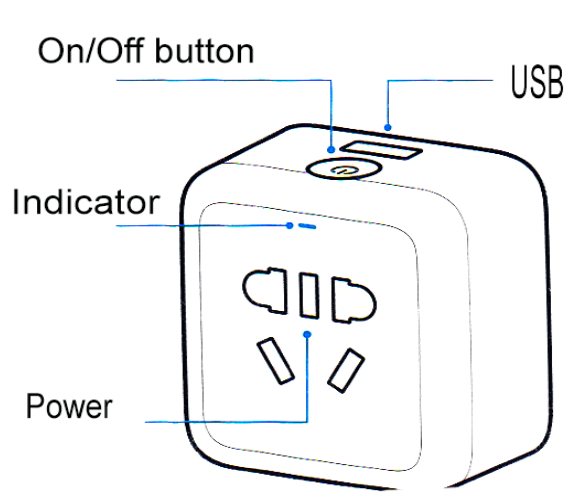

Hold the button to reset to factory settings

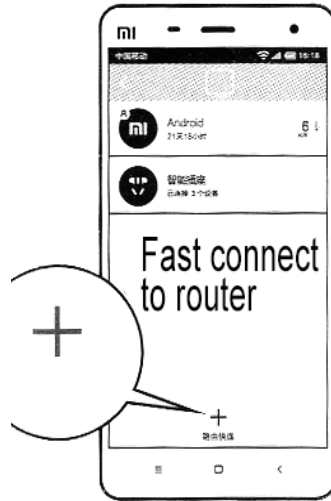

2. Connect to Mi router by one step

- 1) When an indicator is flickering yellow, start Mi router app.
- 2) Find «smart devices» in a list and press «Quick connect to router».
- 3) Blue indicator shows that connection successful.

* Before connection be shure, that you you have 2.4G WIFI signal.

3. Connection without a router

Scan the QR-code to install «Smart Home» app.

- 1) After switching on power start app «Smart Home».
- 2) Wait while a new device appears in devices list, then press «Connect» and wait while the connection is established.
- 3) Blue indicator shows that connection successful.

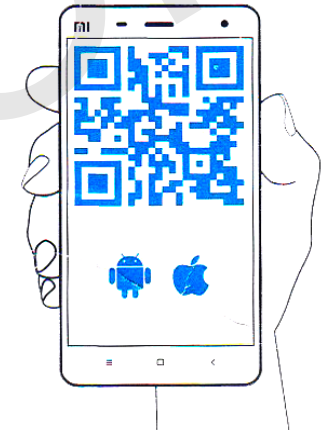

4. Warranty

During the term of warranty you had productive defects, you can take advantage of warranty service:

1. During 7 days from the moment of purchase, in case of origin of problem, after producing of receipt, you can return money or choose free replacement of commodity on the same cost.
2. During 15 days from the moment of purchase, in case of origin of problem, you can take advantage of right on free replacement of commodity on the same cost.

Warranty term of Mi Smart Socket is 1 year from date of purchase. For warranty repair you need have an invoice or an order number.

xiaomi-mi.com

Terms of warranty repair

List of circumstances (including, but not limited to) for which compensation is not possible:

- it is absence of warranty coupon, receipts or term of action of guarantee made off;
- damages arising up at force-majeure circumstances such, as: thunderbolt, fire or flood;;
- damages arising up in investigation of the use of device not on purpose, wrong a care or wrong technical service;
- defects arising up in investigation of technical service in the service centers of other trade mark;
- the model number indicated in the certificate of guarantee, and number, does not coincide on a device;
- a discolouration or wear is in investigation of exploitation of device;

If you ran into the above-mentioned circumstances, you independently must find the decision of problem or take advantage of requiring payment services in a service center.